

ČÍSLO APARTMÁNU
APARTMENT **G405**

PODLAŽIE
FLOOR **4.NP**

ČÍSLO DOMU
BUILDING **V2B**

POČET IZIEB
ROOMS **1**

01. Chodba 01. Hall	4,8 m ²
02. Kuchyňa 02. Kitchen	4,1 m ²
03. Obývacia izba 03. Living room	20,9 m ²
04. Šatník 04. Closet	10,5 m ²
05. Kúpeľňa 05. Bathroom	4,0 m ²
06. WC 06. Toilet	2,0 m ²
07. Šatník 07. Closet	4,1 m ²
Plocha interiéru Interior area	50,4 m²
08. Lodžia 08. Loggia	5,8 m ²

Celková plocha apartmánu
Apartment area **56,20 m²**

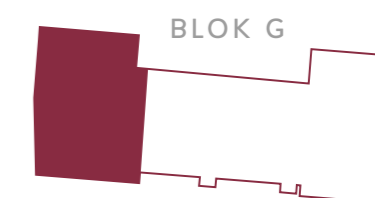
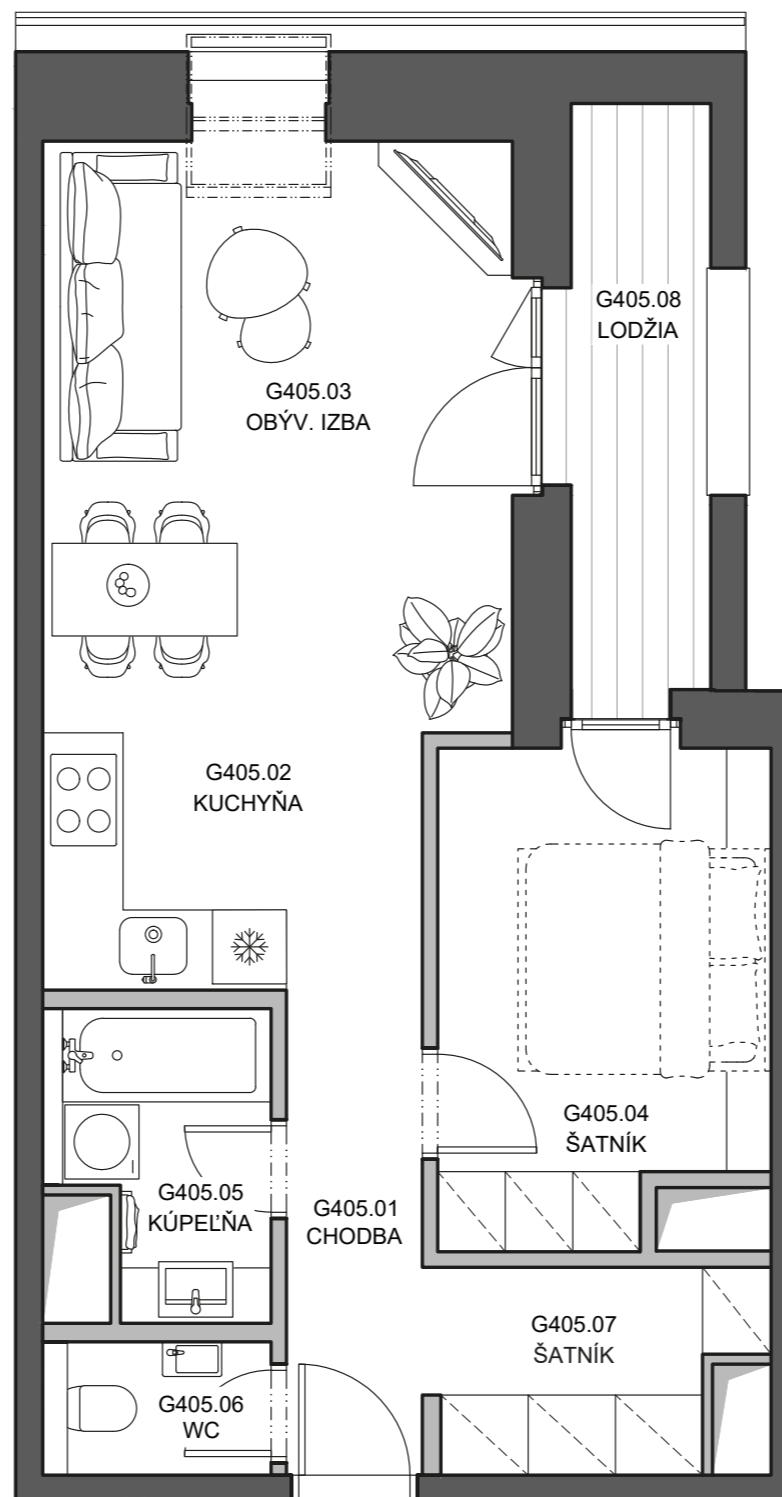

DEVELOPER:
VYDRICA DEVELOPMENT, a.s.
STEINERKA Business Center
Legionárska 10, 811 07 Bratislava

PREDAJ/SALES:
+421 910 635 645 | predaj@vydrica.com
www.vydrica.com

ČÍSLO APARTMÁNU
APARTMENT **G405**

PODLAŽIE
FLOOR **4.NP**

ČÍSLO DOMU
BUILDING **V2B**

POČET IZIEB
ROOMS **1**

01. Chodba 01. Hall	4,8 m ²
02. Kuchyňa 02. Kitchen	4,1 m ²
03. Obývacia izba 03. Living room	20,9 m ²
04. Šatník 04. Closet	10,5 m ²
05. Kúpeľňa 05. Bathroom	4,0 m ²
06. WC 06. Toilet	2,0 m ²
07. Šatník 07. Closet	4,1 m ²
Plocha interiéru Interior area	50,4 m²
08. Lodžia 08. Loggia	5,8 m ²

Celková plocha apartmánu
Apartment area **56,20 m²**

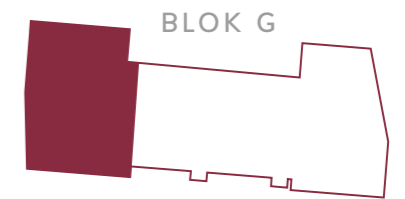
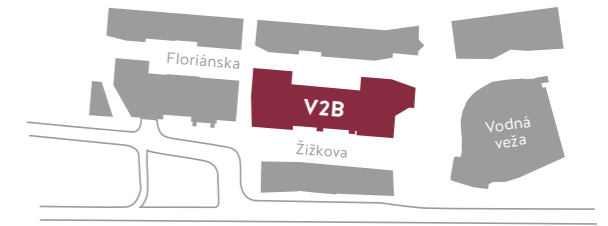
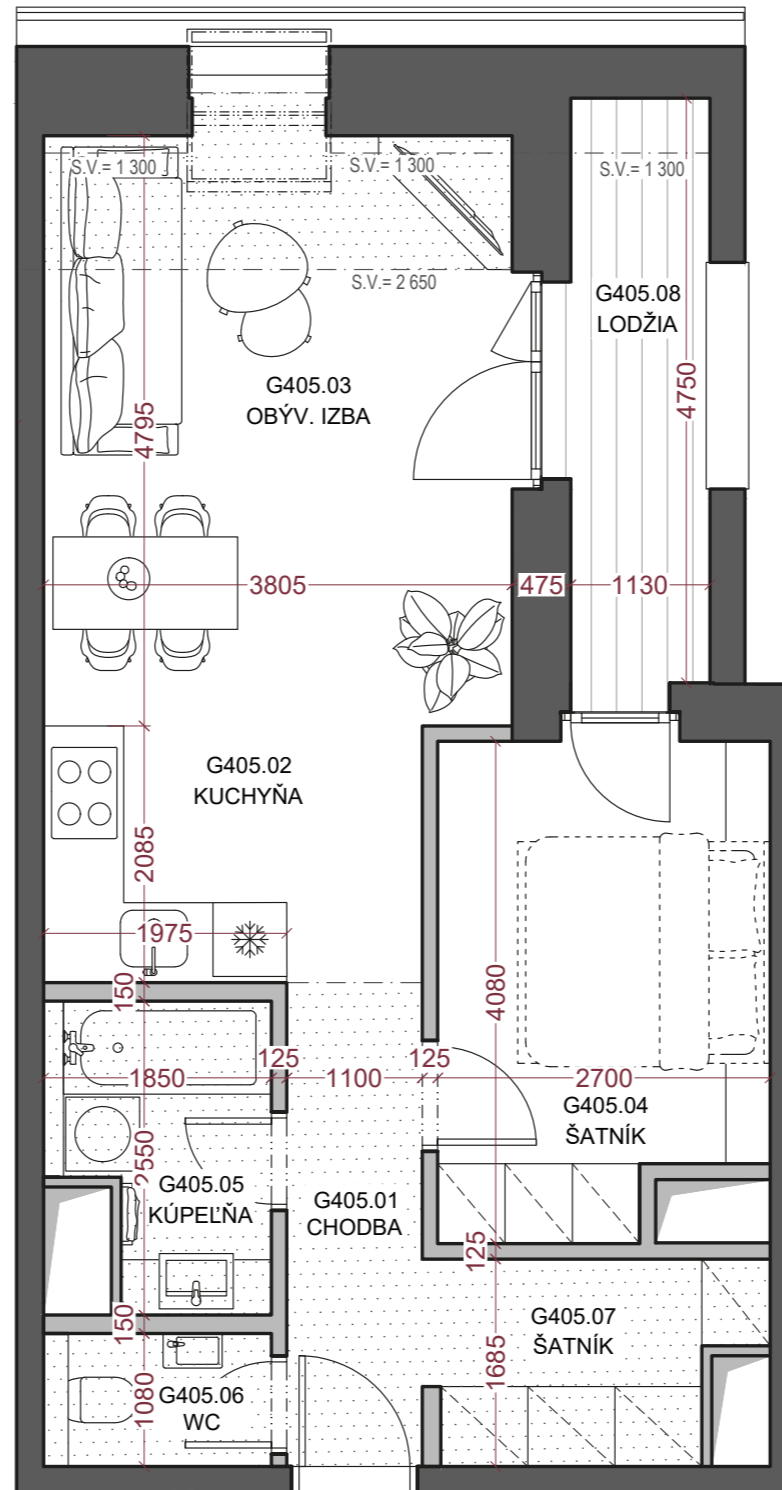

Plocha priestorov pod svetlou výškou do 1,3 m vo výmere **1,50 m²** nie je započítaná do plochy apartmánu.

The part of the premises where floor-to-ceiling height is below 1,3 m, which means the area of **1,50 m²**, is not included in the whole area of the apartment.

..... Znížená svetlá výška
Lowered floor-to-ceiling height

DEVELOPER:
VYDRICA DEVELOPMENT, a.s.
STEINERKA Business Center
Legionárska 10, 811 07 Bratislava

PREDAJ/SALES:
+421 910 635 645 | predaj@vydrica.com
www.vydrica.com

