

**ČÍSLO APARTMÁNU** **A603**  
 APARTMENT

**PODLAŽIE** **6.NP**  
 FLOOR

**ČÍSLO DOMU** **V1A**  
 BUILDING

**POČET IZIEB** **2**  
 ROOMS

- 01. Chodba 9,3 m<sup>2</sup>  
01. Hall
- 02. Kuchyňa 6,1 m<sup>2</sup>  
02. Kitchen
- 03. Obývacia izba 10,6 m<sup>2</sup>  
03. Living room
- 04. Izba 13,5 m<sup>2</sup>  
04. Room
- 05. Kúpeľňa 5,9 m<sup>2</sup>  
05. Bathroom

**Plocha interiéru** **45,4 m<sup>2</sup>**  
 Interior area

**Celková plocha apartmánu** **45,40 m<sup>2</sup>**  
 Apartment area

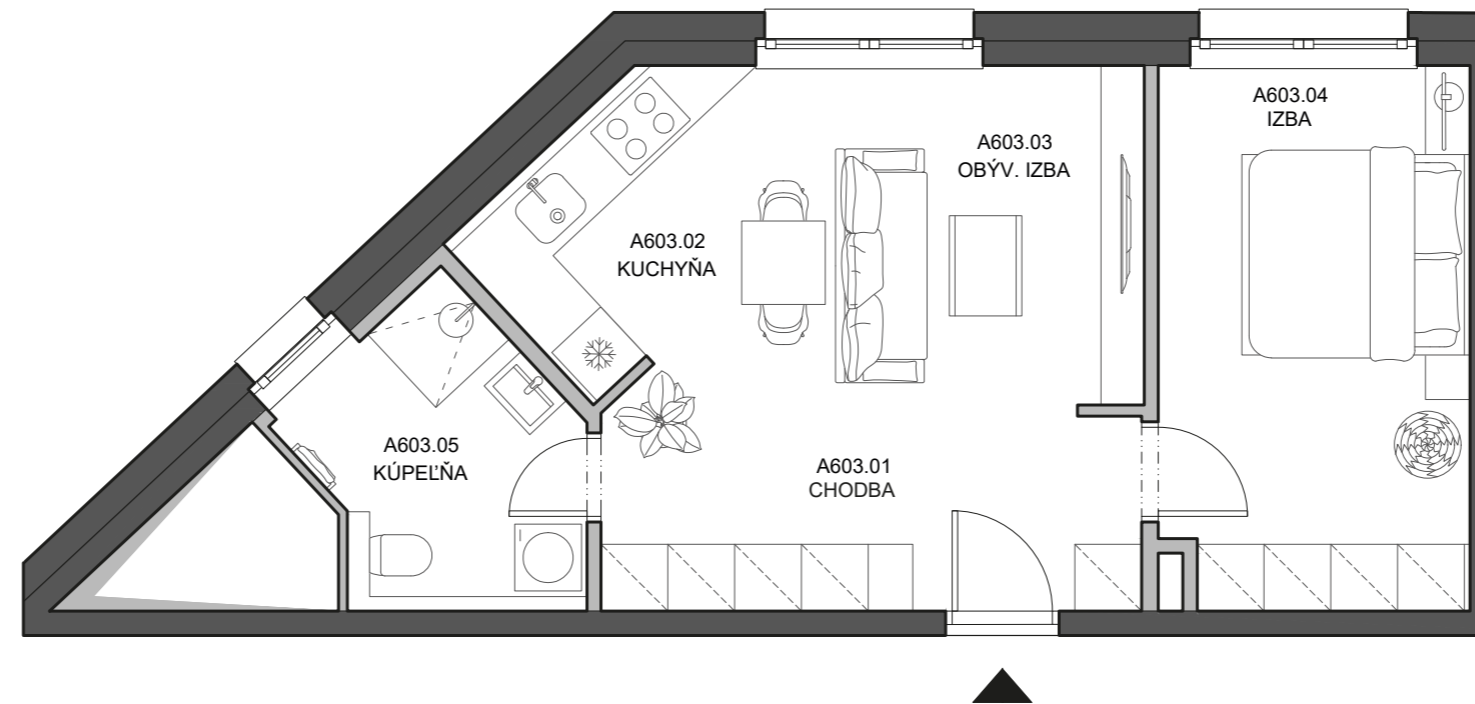

BLOK A

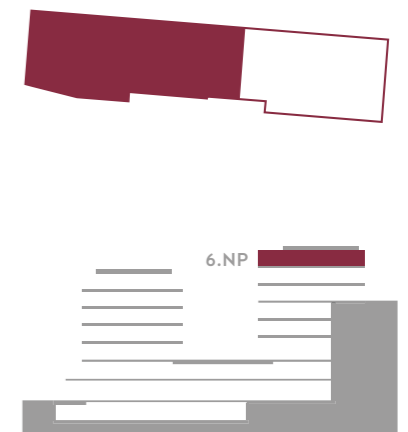

**DEVELOPER:**  
 VYDRICA DEVELOPMENT, a.s.  
 STEINERKA Business Center  
 Legionárska 10, 811 07 Bratislava

**PREDAJ/SALES:**  
 +421 910 635 645 | predaj@vydrica.com  
 www.vydrica.com

ČÍSLO APARTMÁNU  
APARTMENT **A603**

PODLAŽIE  
FLOOR **6.NP**

ČÍSLO DOMU  
BUILDING **V1A**

POČET IZIEB  
ROOMS **2**

01. Chodba 01. Hall	9,3 m <sup>2</sup>
02. Kuchyňa 02. Kitchen	6,1 m <sup>2</sup>
03. Obývacia izba 03. Living room	10,6 m <sup>2</sup>
04. Izba 04. Room	13,5 m <sup>2</sup>
05. Kúpeľňa 05. Bathroom	5,9 m <sup>2</sup>

**Plocha interiéru**  
Interior area **45,4 m<sup>2</sup>**

**Celková plocha apartmánu**  
Apartment area **45,40 m<sup>2</sup>**

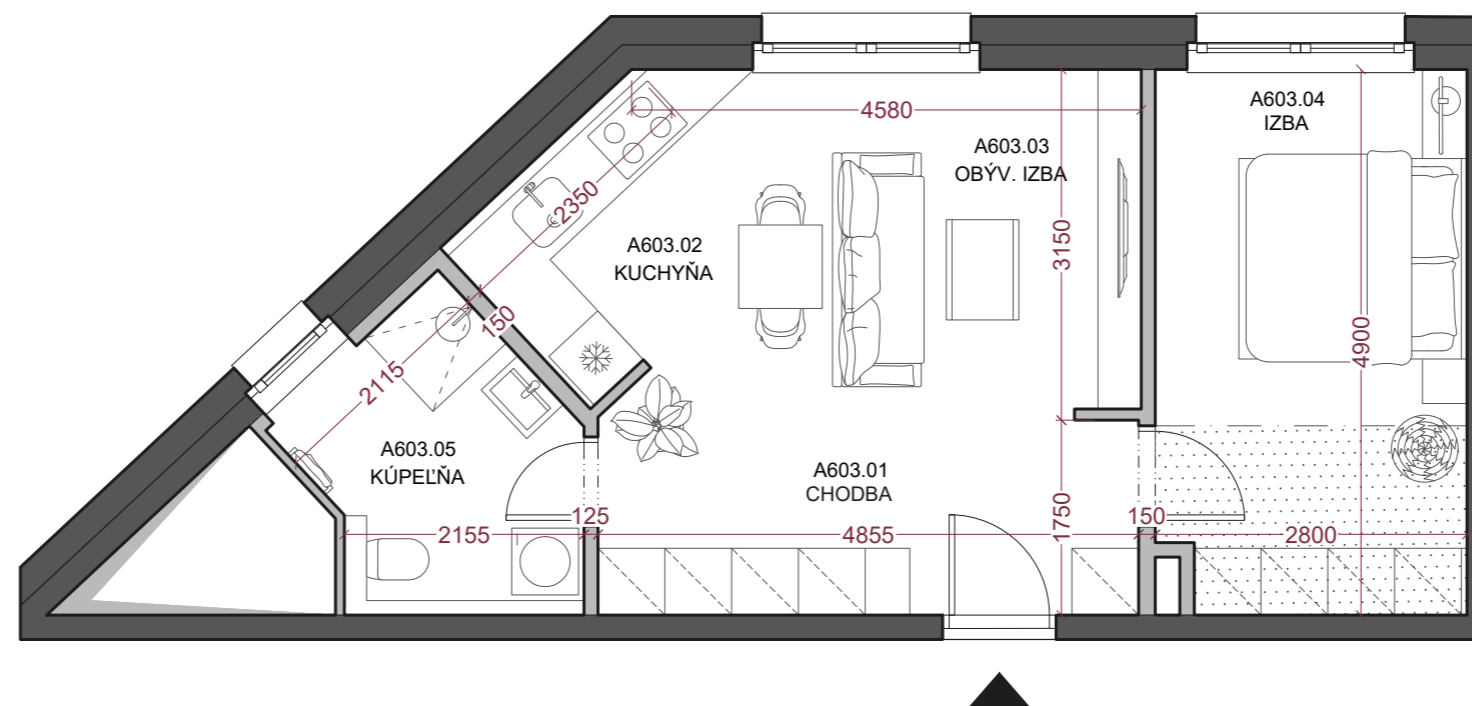

BLOK A

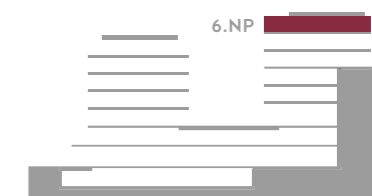

Plocha priestorov pod svetlou výškou do 1,3 m vo výmere - m<sup>2</sup> nie je započítaná do plochy apartmánu.

The part of the premises where floor-to-ceiling height is below 1,3 m, which means the area of - m<sup>2</sup>, is not included in the whole area of the apartment.

..... Znížená svetlá výška  
Lowered floor-to-ceiling height

**DEVELOPER:**  
VYDRICA DEVELOPMENT, a.s.  
STEINERKA Business Center  
Legionárska 10, 811 07 Bratislava

**PREDAJ/SALES:**  
+421 910 635 645 | predaj@vydrica.com  
www.vydrica.com