

ČÍSLO APARTMÁNU
APARTMENT **H1004**

PODLAŽIE
FLOOR **1.PP**

ČÍSLO DOMU
BUILDING **V2B**

POČET IZIEB
ROOMS **1**

01. Chodba 01. Hall	9,3 m ²
02. Kuchyňa 02. Kitchen	5,2 m ²
03. Obývacia izba 03. Living room	10,5 m ²
04. Spací kút 04. Sleeping corner	7,5 m ²
05. Kúpeľňa 05. Bathroom	4,6 m ²
06. Šatník 06. Closet	2,5 m ²
Plocha interiéru Interior area	39,6 m²
07. Terasa 07. Terrace	6,7 m ²

Celková plocha apartmánu
Apartment area **46,30 m²**

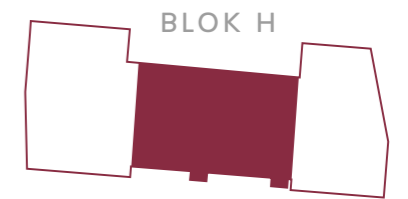
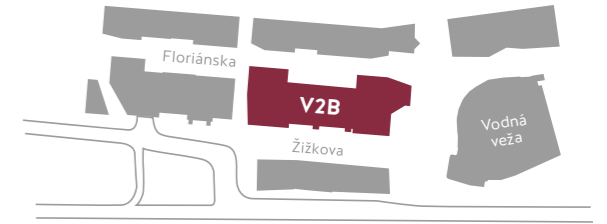
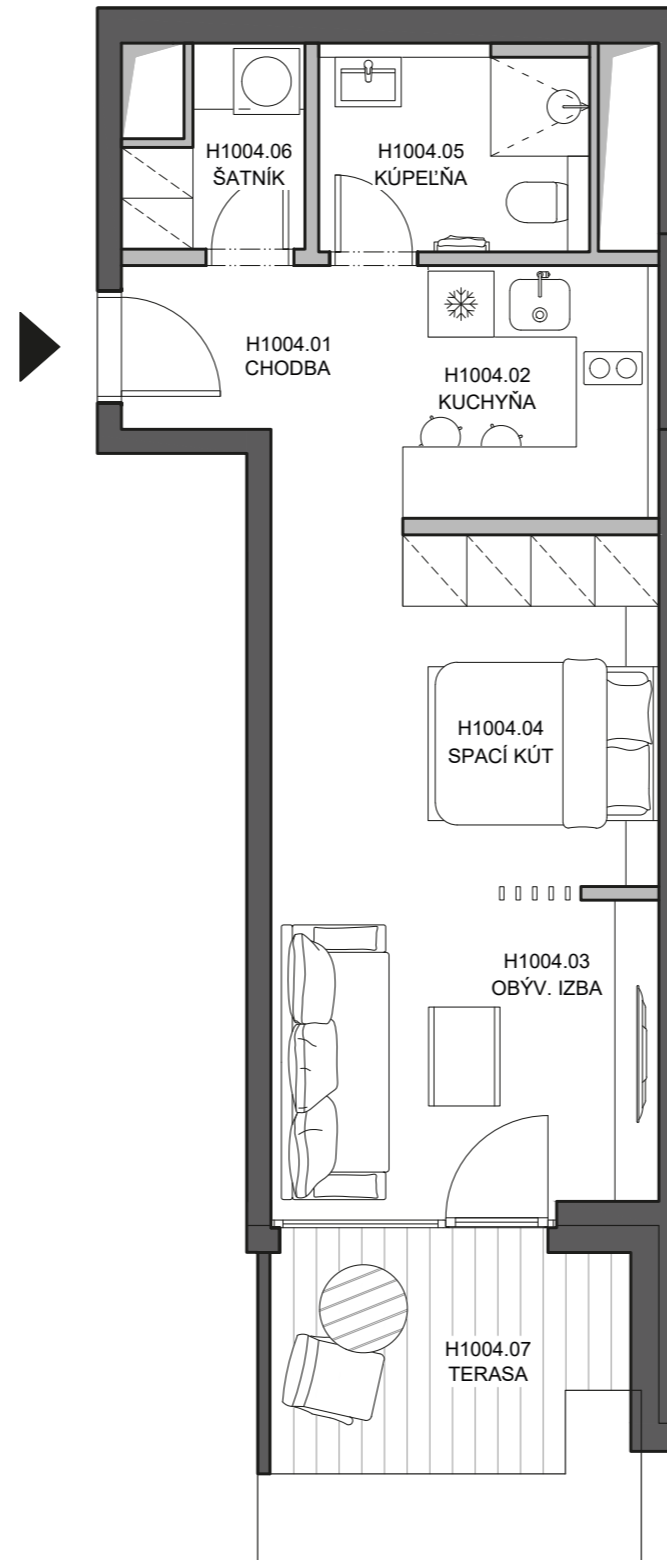

DEVELOPER:
VYDRICA DEVELOPMENT, a.s.
STEINERKA Business Center
Legionárska 10, 811 07 Bratislava

PREDAJ/SALES:
+421 910 635 645 | predaj@vydrica.com
www.vydrica.com

ČÍSLO APARTMÁNU
APARTMENT **H1004**

PODLAŽIE
FLOOR **1.PP**

ČÍSLO DOMU
BUILDING **V2B**

POČET IZIEB
ROOMS **1**

01. Chodba 01. Hall	9,3 m ²
02. Kuchyňa 02. Kitchen	5,2 m ²
03. Obývacia izba 03. Living room	10,5 m ²
04. Spací kút 04. Sleeping corner	7,5 m ²
05. Kúpeľňa 05. Bathroom	4,6 m ²
06. Šatník 06. Closet	2,5 m ²
Plocha interiéru Interior area	39,6 m²
07. Terasa 07. Terrace	6,7 m ²

Celková plocha apartmánu
Apartment area **46,30 m²**

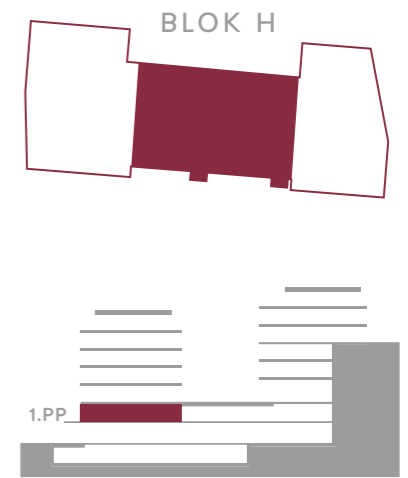
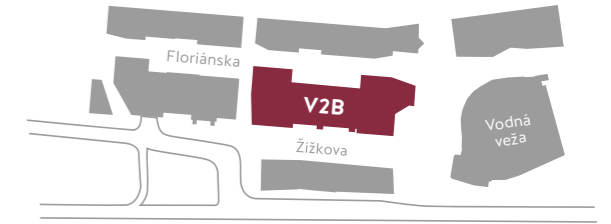
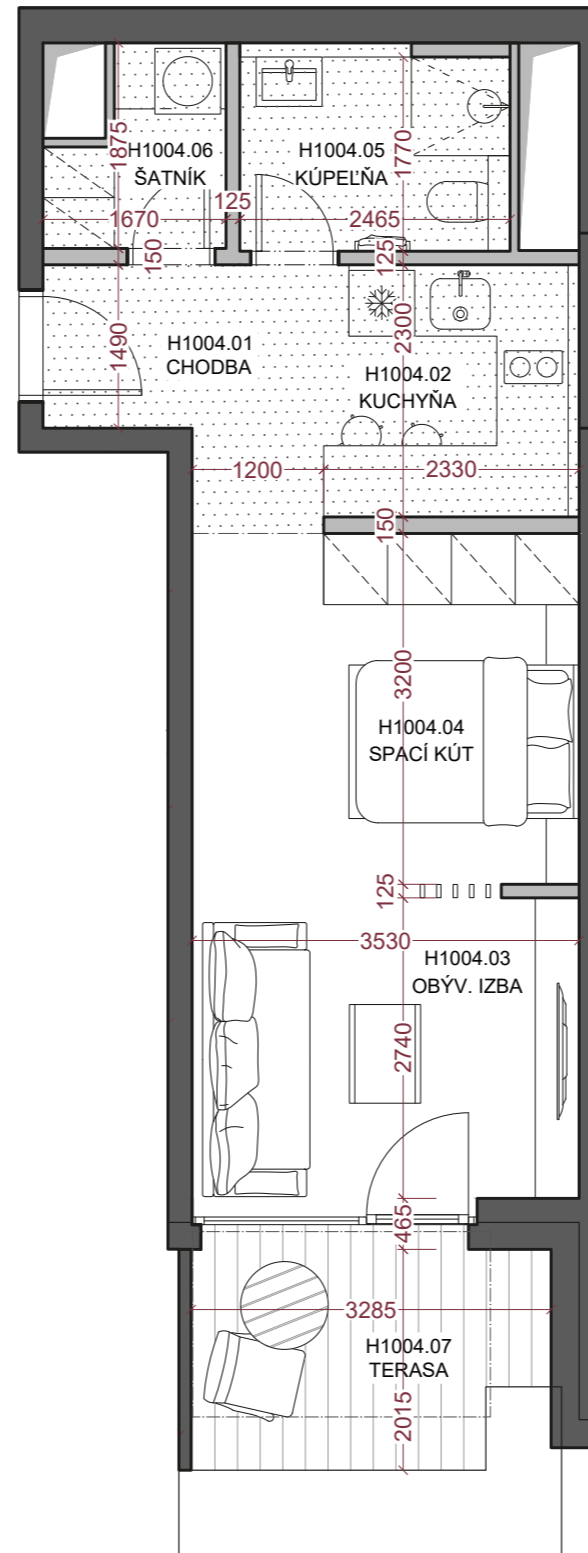

Plocha priestorov pod svetlou výškou do 1,3 m vo výmere - m² nie je započítaná do plochy apartmánu.

The part of the premises where floor-to-ceiling height is below 1,3 m, which means the area of - m², is not included in the whole area of the apartment.

..... Znížená svetlá výška
..... Lowered floor-to-ceiling height

DEVELOPER:
VYDRICA DEVELOPMENT, a.s.
STEINERKA Business Center
Legionárska 10, 811 07 Bratislava

PREDAJ/SALES:
+421 910 635 645 | predaj@vydrica.com
www.vydrica.com

