

ČÍSLO APARTMÁNU  
APARTMENT **H1003**

PODLAŽIE  
FLOOR **1.PP**

ČÍSLO DOMU  
BUILDING **V2B**

POČET IZIEB  
ROOMS **1**

01. Chodba 01. Hall	4,4 m <sup>2</sup>
02. Obývacia izba 02. Living room	14,1 m <sup>2</sup>
03. Kúpeľňa 03. Bathroom	3,9 m <sup>2</sup>
<b>Plocha interiéru</b> Interior area	<b>22,4 m<sup>2</sup></b>
04. Terasa 04. Terrace	7,8 m <sup>2</sup>

**Celková plocha apartmánu**  
Apartment area **30,20 m<sup>2</sup>**

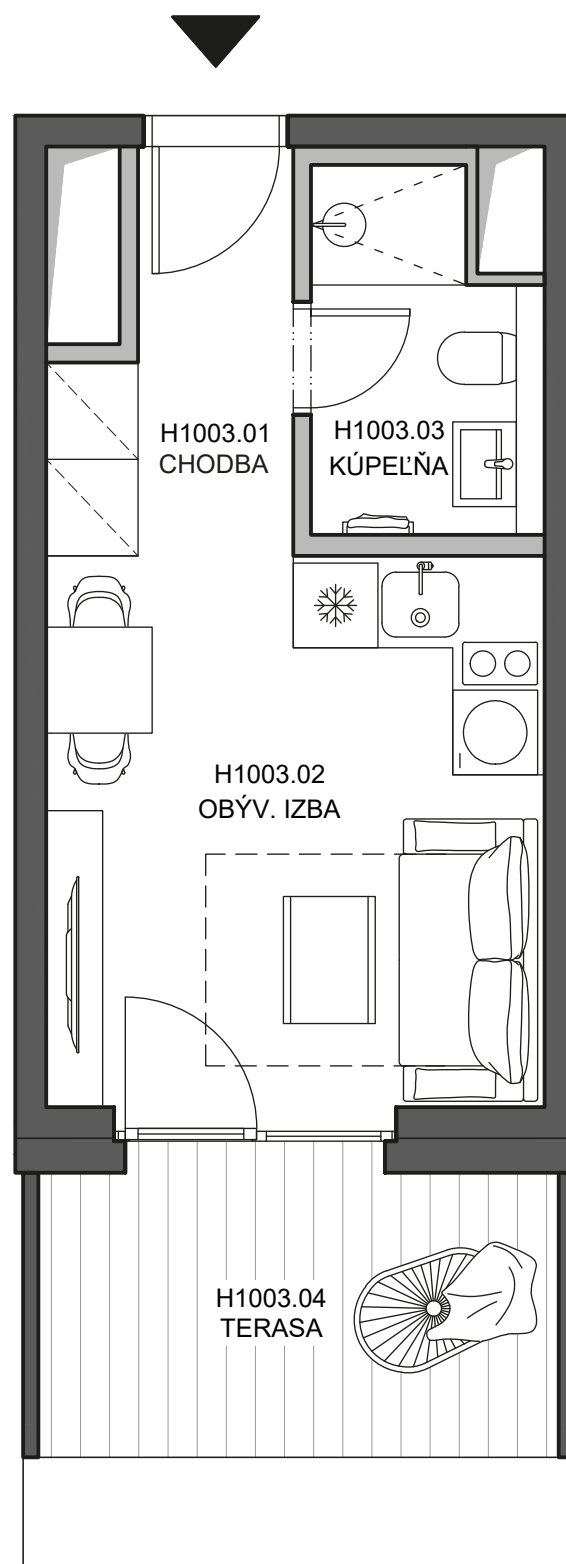

**DEVELOPER:**  
VYDRICA DEVELOPMENT, a.s.  
STEINERKA Business Center  
Legionárska 10, 811 07 Bratislava

**PREDAJ/SALES:**  
+421 910 635 645 | predaj@vydrica.com  
www.vydrica.com

ČÍSLO APARTMÁNU  
APARTMENT **H1003**

PODLAŽIE  
FLOOR **1.PP**

ČÍSLO DOMU  
BUILDING **V2B**

POČET IZIEB  
ROOMS **1**

01. Chodba 01. Hall	4,4 m <sup>2</sup>
02. Obývacia izba 02. Living room	14,1 m <sup>2</sup>
03. Kúpeľňa 03. Bathroom	3,9 m <sup>2</sup>
<b>Plocha interiéru</b> Interior area	<b>22,4 m<sup>2</sup></b>
04. Terasa 04. Terrace	7,8 m <sup>2</sup>

**Celková plocha apartmánu**  
Apartment area **30,20 m<sup>2</sup>**

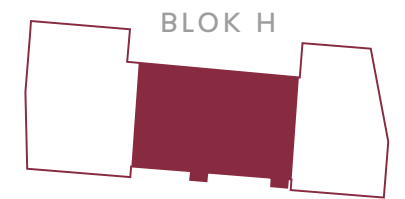
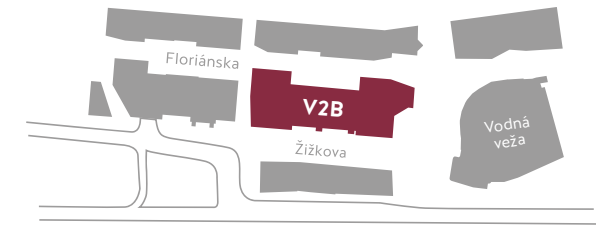
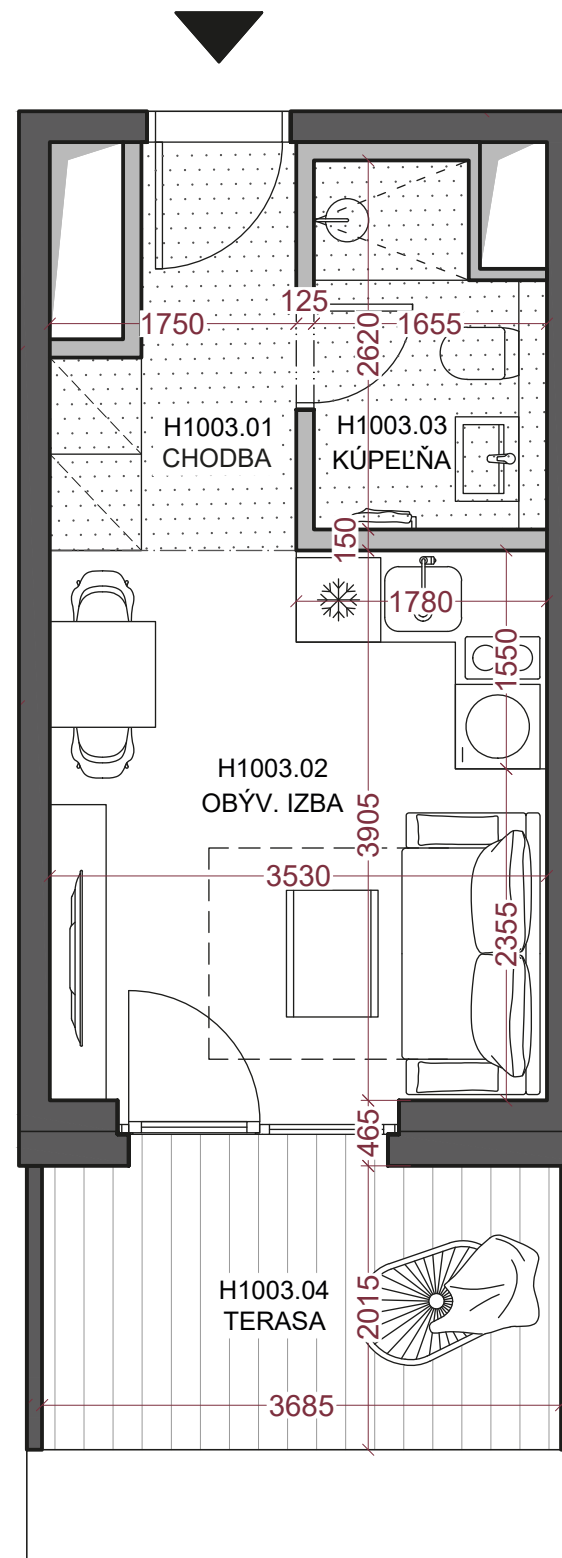

Plocha priestorov pod svetlou výškou do 1,3 m vo výmere - m<sup>2</sup> nie je započítaná do plochy apartmánu.

The part of the premises where floor-to-ceiling height is below 1,3 m, which means the area of - m<sup>2</sup>, is not included in the whole area of the apartment.

..... Znížená svetlá výška  
..... Lowered floor-to-ceiling height

**DEVELOPER:**  
VYDRICA DEVELOPMENT, a.s.  
STEINERKA Business Center  
Legionárska 10, 811 07 Bratislava

**PREDAJ/SALES:**  
+421 910 635 645 | predaj@vydrica.com  
www.vydrica.com