

ČÍSLO APARTMÁNU **D508**
APARTMENT

PODLAŽIE **5.NP**
FLOOR

ČÍSLO DOMU **V1B**
BUILDING

POČET IZIEB **2**
ROOMS

- 01. Chodba 5,6 m²
01. Hall
- 02. Kuchyňa 5,0 m²
02. Kitchen
- 03. Obývacia izba 11,7 m²
03. Living room
- 04. Izba 12,2 m²
04. Room
- 05. Kúpeľňa 4,4 m²
05. Bathroom

Plocha interiéru **38,9 m²**
Interior area

Celková plocha apartmánu **38,90 m²**
Apartment area

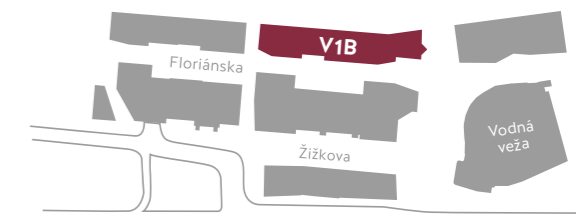
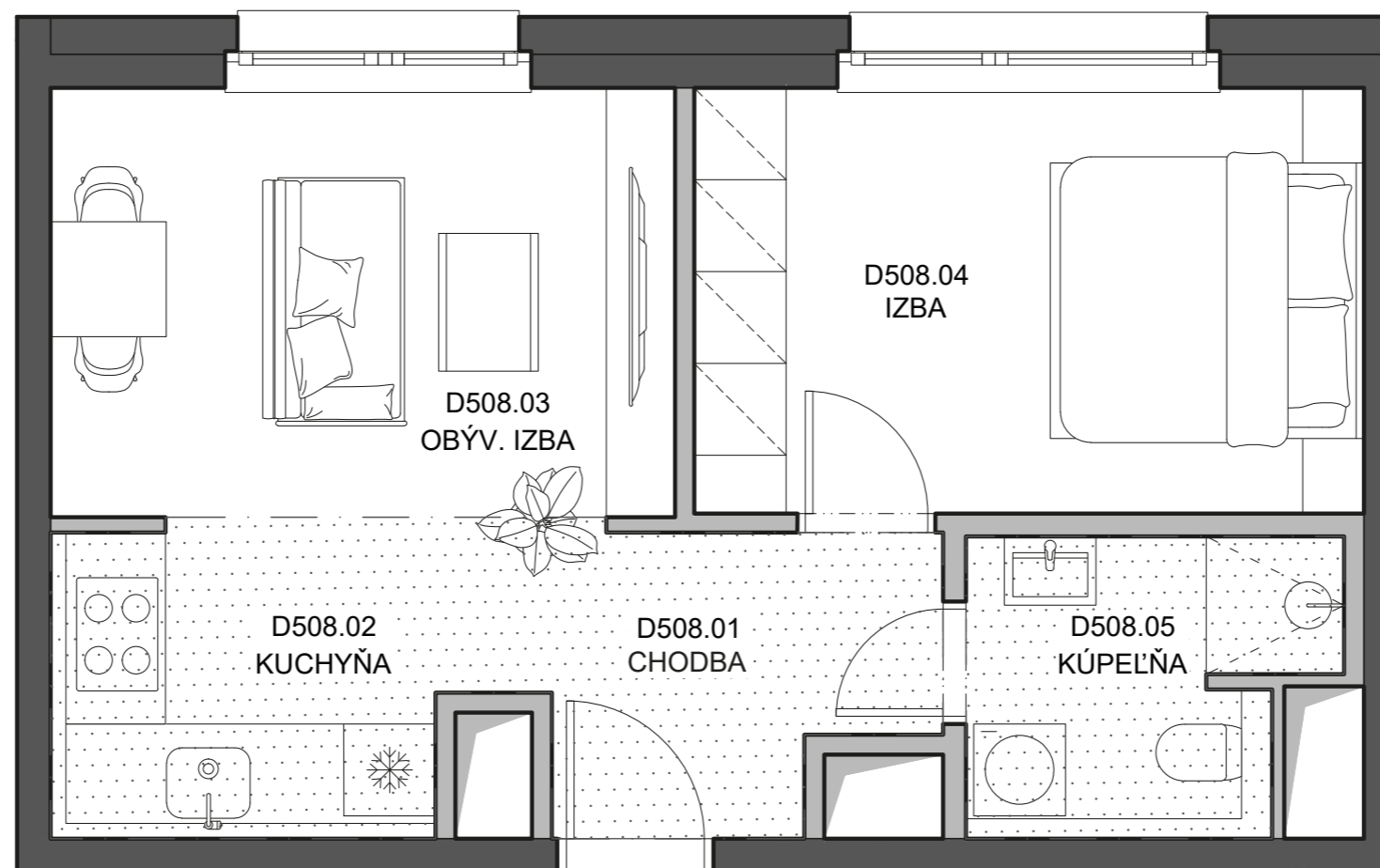

BLOK D

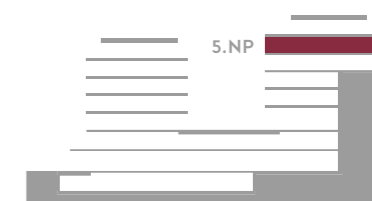

..... Znížená svetlá výška
Lowered floor-to-ceiling height

DEVELOPER:
VYDRICA DEVELOPMENT, a.s.
STEINERKA Business Center
Legionárska 10, 811 07 Bratislava

PREDAJ/SALES:
+421 910 635 645 | predaj@vydrica.com
www.vydrica.com



ČÍSLO APARTMÁNU **D508**
APARTMENT

PODLAŽIE **5.NP**
FLOOR

ČÍSLO DOMU **V1B**
BUILDING

POČET IZIEB **2**
ROOMS

- 01. Chodba 5,6 m²
01. Hall
- 02. Kuchyňa 5,0 m²
02. Kitchen
- 03. Obývacia izba 11,7 m²
03. Living room
- 04. Izba 12,2 m²
04. Room
- 05. Kúpeľňa 4,4 m²
05. Bathroom

Plocha interiéru **38,9 m²**
Interior area

Celková plocha apartmánu **38,90 m²**
Apartment area

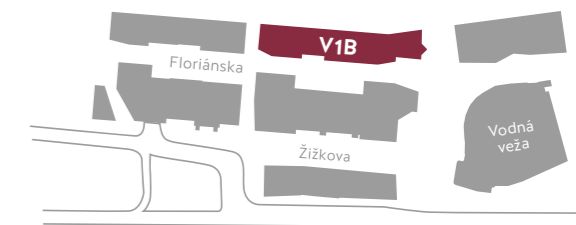
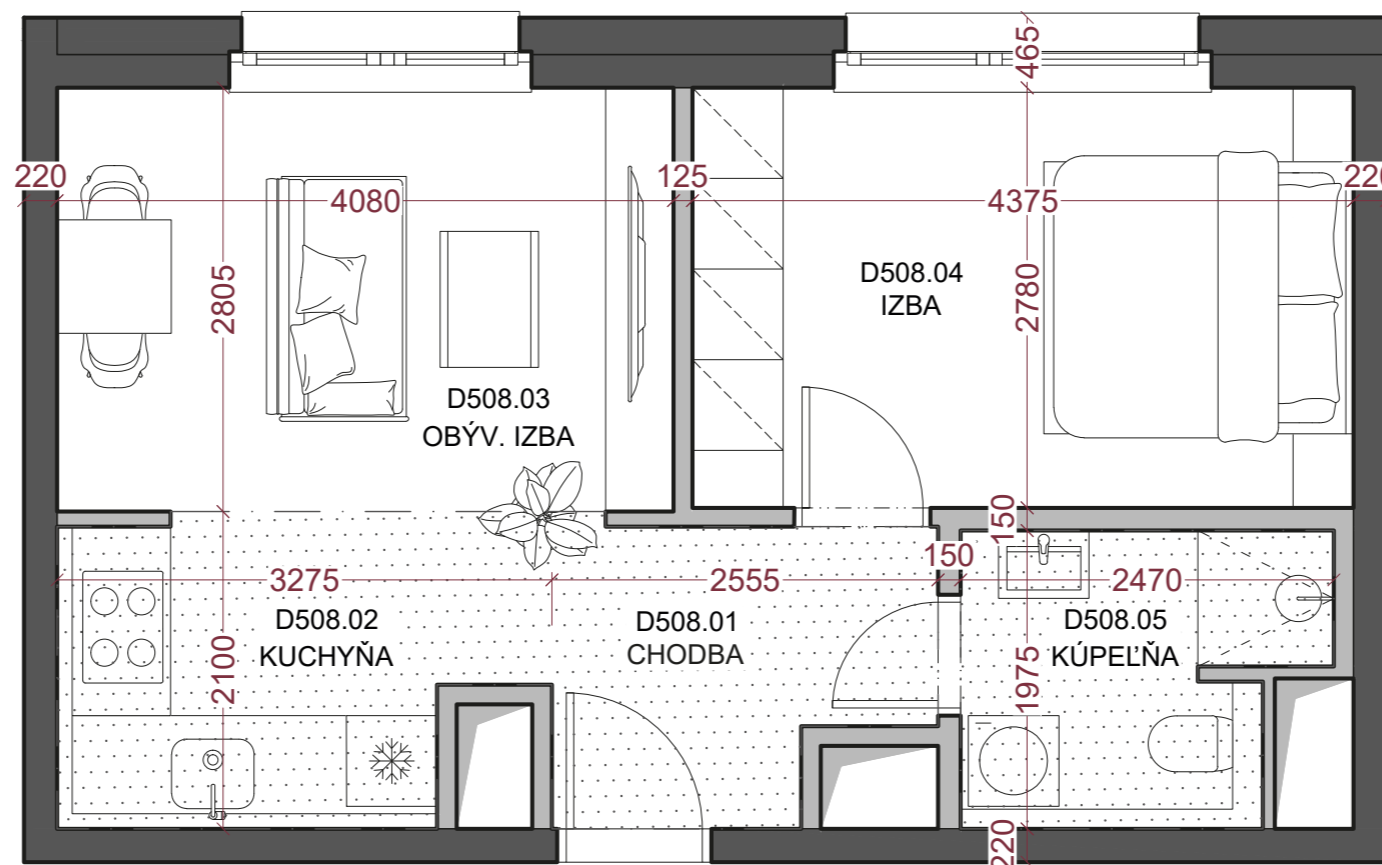

BLOK D

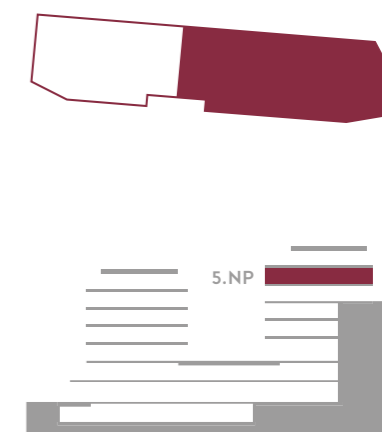

Plocha priestorov pod svetlou výškou do 1,3 m vo výmere - m² nie je započítaná do plochy apartmánu.

The part of the premises where floor-to-ceiling height is below 1,3 m, which means the area of - m², is not included in the whole area of the apartment.

..... Znížená svetlá výška
Lowered floor-to-ceiling height

DEVELOPER:
VYDRICA DEVELOPMENT, a.s.
STEINERKA Business Center
Legionárska 10, 811 07 Bratislava

PREDAJ/SALES:
+421 910 635 645 | predaj@vydrica.com
www.vydrica.com

