

ČÍSLO APARTMÁNU **E206**
APARTMENT

PODLAŽIE **2.NP**
FLOOR

ČÍSLO DOMU **V2A**
BUILDING

POČET IZIEB **2**
ROOMS

01. Chodba	5,3 m ²
01. Hall	
02. Kúpeľňa	5,8 m ²
02. Bathroom	
03. Kuchyňa	9,5 m ²
03. Kitchen	
04. Obývacia izba	13,7 m ²
04. Living room	
05. Izba	13,1 m ²
05. Room	

Plocha interiéru **47,4 m²**
Interior area

Celková plocha apartmánu **47,40 m²**
Apartment area

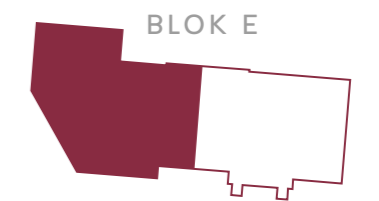
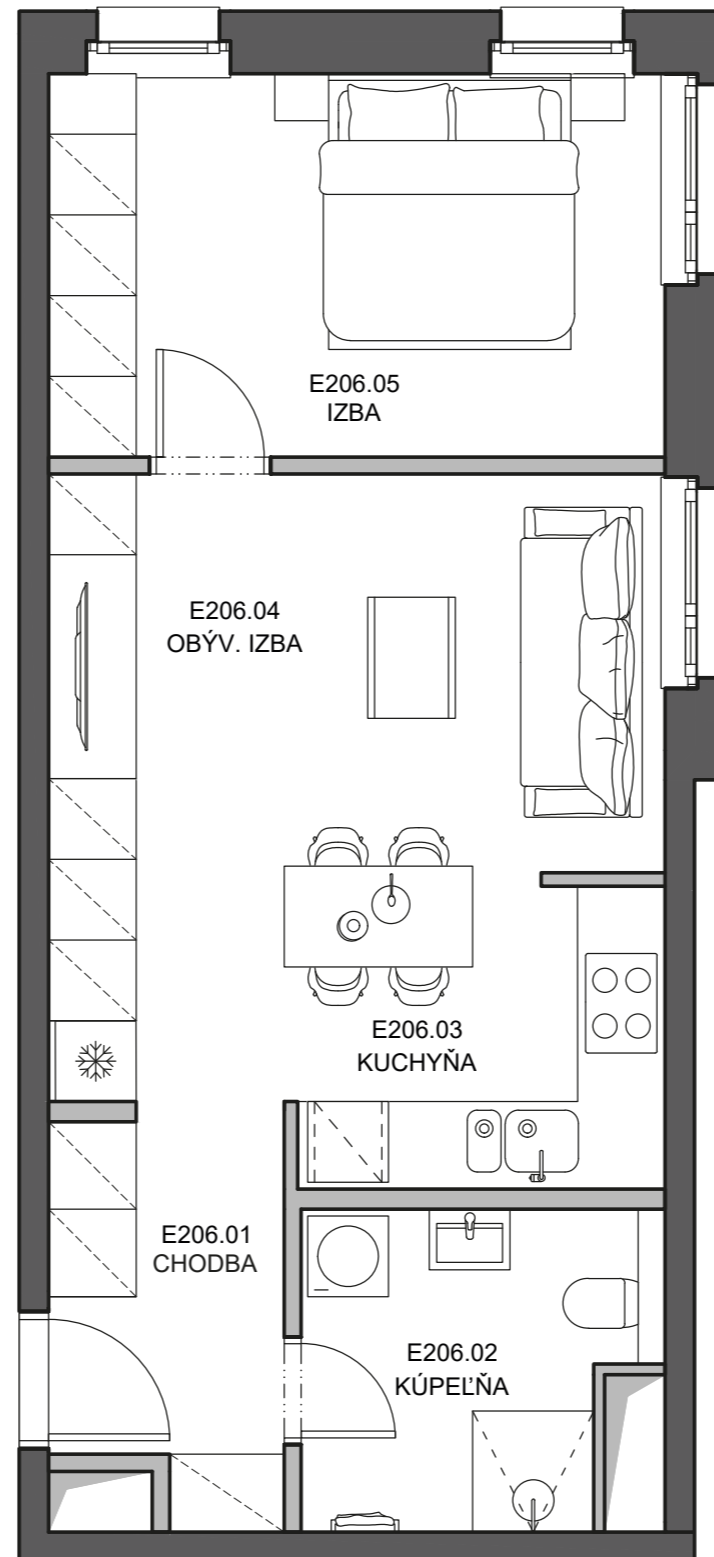

DEVELOPER:
VYDRICA DEVELOPMENT, a.s.
STEINERKA Business Center
Legionárska 10, 811 07 Bratislava

PREDAJ/SALES:
+421 910 635 645 | predaj@vydrica.com
www.vydrica.com

ČÍSLO APARTMÁNU
APARTMENT **E206**

PODLAŽIE
FLOOR **2.NP**

ČÍSLO DOMU
BUILDING **V2A**

POČET IZIEB
ROOMS **2**

- 01. Chodba 5,3 m²
01. Hall
- 02. Kúpeľňa 5,8 m²
02. Bathroom
- 03. Kuchyňa 9,5 m²
03. Kitchen
- 04. Obývacia izba 13,7 m²
04. Living room
- 05. Izba 13,1 m²
05. Room

Plocha interiéru
Interior area **47,4 m²**

Celková plocha apartmánu
Apartment area **47,40 m²**

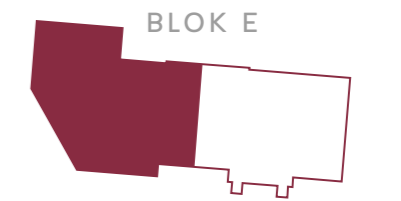
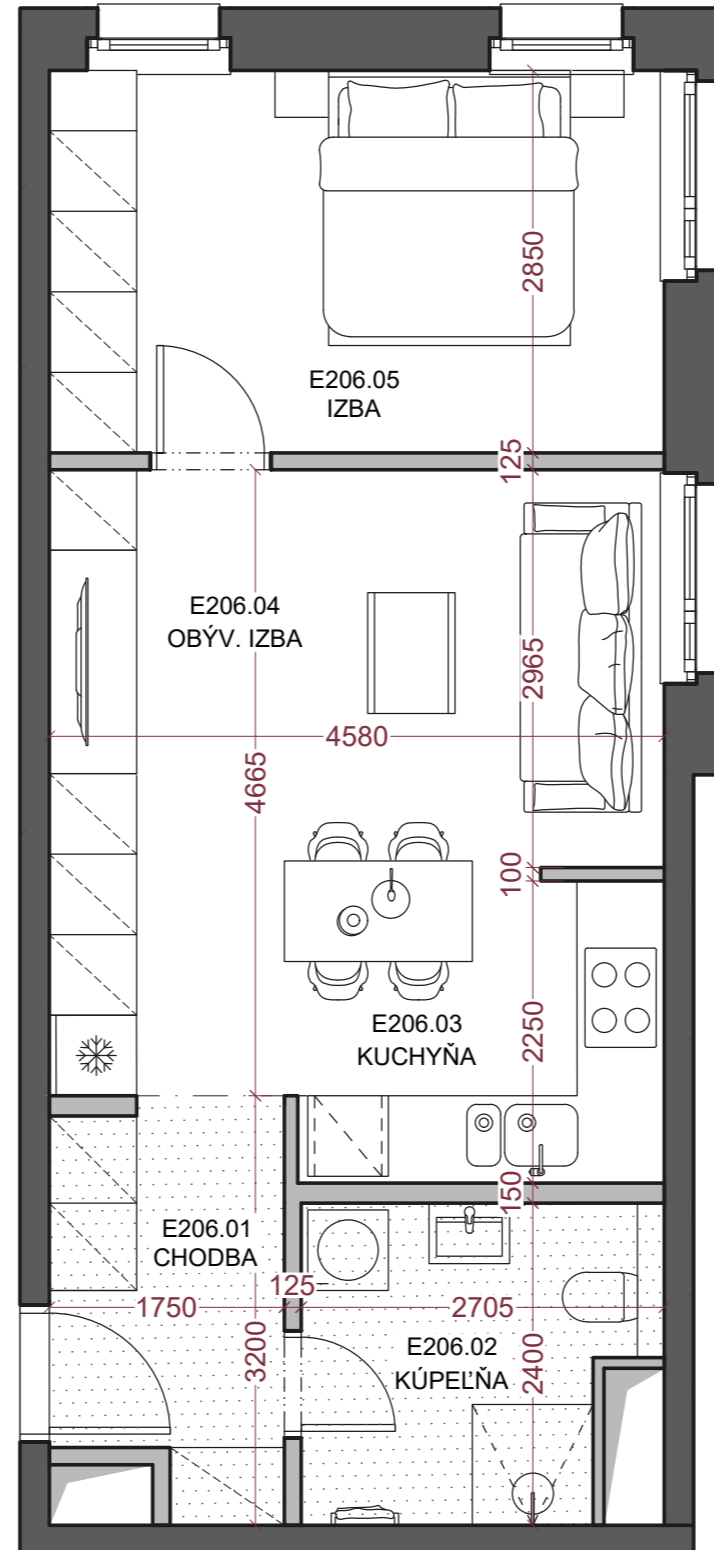

Plocha priestorov pod svetlou výškou do 1,3 m vo výmere - m² nie je započítaná do plochy apartmánu.

The part of the premises where floor-to-ceiling height is below 1,3 m, which means the area of - m², is not included in the whole area of the apartment.

..... Znížená svetlá výška
..... Lowered floor-to-ceiling height

DEVELOPER:
VYDRICA DEVELOPMENT, a.s.
STEINERKA Business Center
Legionárska 10, 811 07 Bratislava

PREDAJ/SALES:
+421 910 635 645 | predaj@vydrica.com
www.vydrica.com