

ČÍSLO APARTMÁNU  
APARTMENT

**G1004**

PODLAŽIE  
FLOOR

**1.PP**

ČÍSLO DOMU  
BUILDING

**V2B**

POČET IZIEB  
ROOMS

**1**

01. Chodba 01. Hall	4,4 m <sup>2</sup>
02. Kuchyňa 02. Kitchen	6,7 m <sup>2</sup>
03. Obývacia izba 03. Living room	14,3 m <sup>2</sup>
04. Šatník 04. Closet	6,1 m <sup>2</sup>
05. Kúpeľňa 05. Bathroom	5,5 m <sup>2</sup>
06. Šatník 06. Closet	2,8 m <sup>2</sup>
<b>Plocha interiéru</b> Interior area	<b>39,8 m<sup>2</sup></b>
07. Lodžia 07. Loggia	8,9 m <sup>2</sup>
<b>Celková plocha apartmánu</b> Apartment area	<b>48,70 m<sup>2</sup></b>

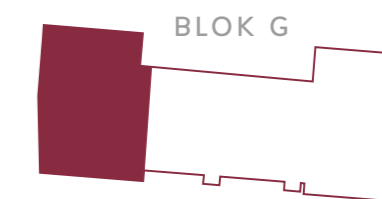
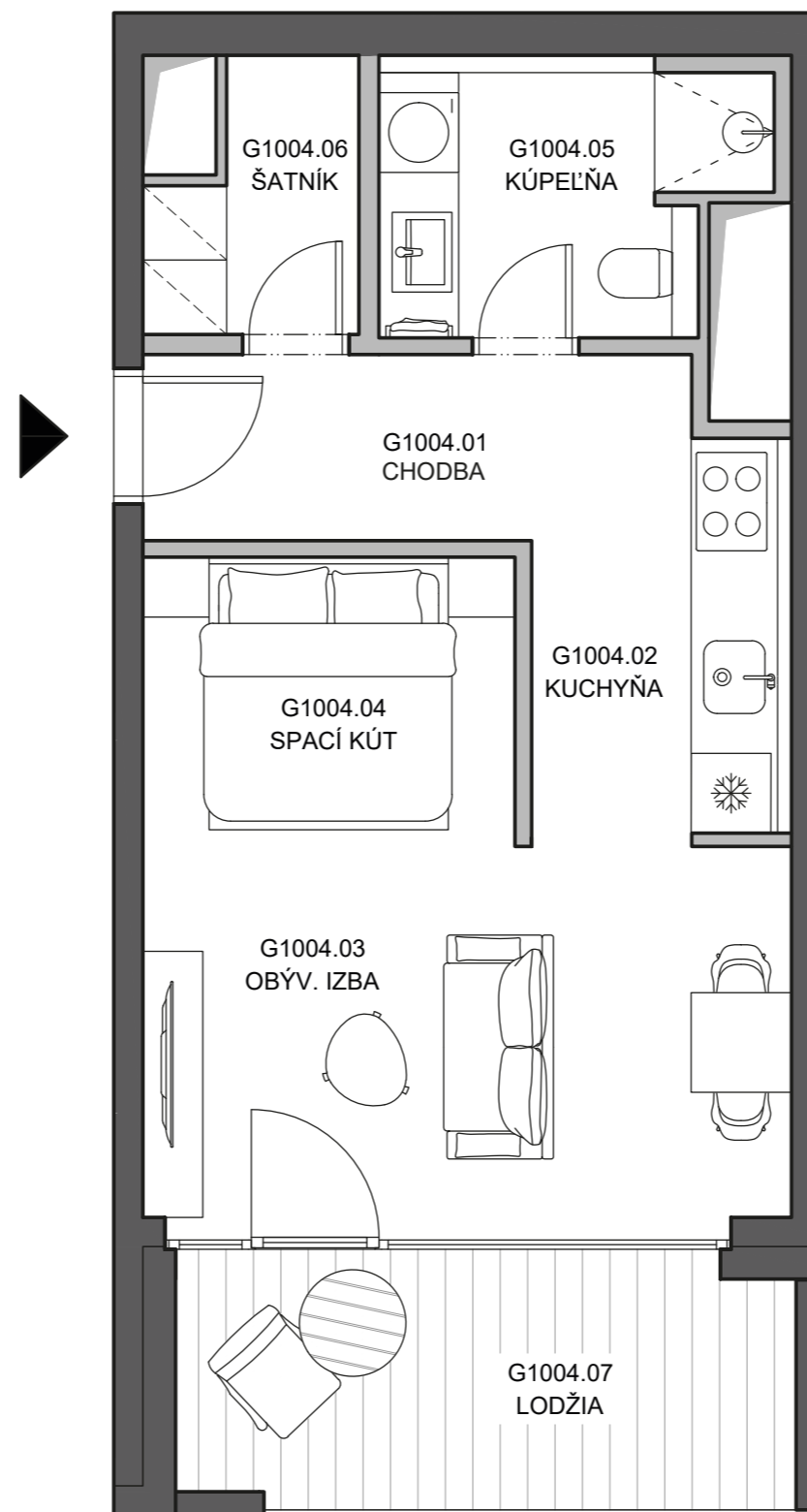

**DEVELOPER:**  
VYDRICA DEVELOPMENT, a.s.  
STEINERKA Business Center  
Legionárska 10, 811 07 Bratislava

**PREDAJ/SALES:**  
+421 910 635 645 | predaj@vydrica.com  
www.vydrica.com

**ČÍSLO APARTMÁNU**  
APARTMENT **G1004**

**PODLAŽIE**  
FLOOR **1.PP**

**ČÍSLO DOMU**  
BUILDING **V2B**

**POČET IZIEB**  
ROOMS **1**

01. Chodba	4,4 m <sup>2</sup>
01. Hall	
02. Kuchyňa	6,7 m <sup>2</sup>
02. Kitchen	
03. Obývacia izba	14,3 m <sup>2</sup>
03. Living room	
04. Šatník	6,1 m <sup>2</sup>
04. Closet	
05. Kúpeľňa	5,5 m <sup>2</sup>
05. Bathroom	
06. Šatník	2,8 m <sup>2</sup>
06. Closet	
<b>Plocha interiéru</b>	<b>39,8 m<sup>2</sup></b>
Interior area	
07. Lodžia	8,9 m <sup>2</sup>
07. Loggia	

**Celková plocha apartmánu**  
Apartment area **48,70 m<sup>2</sup>**

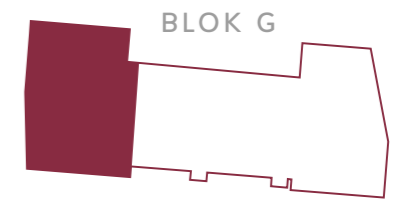
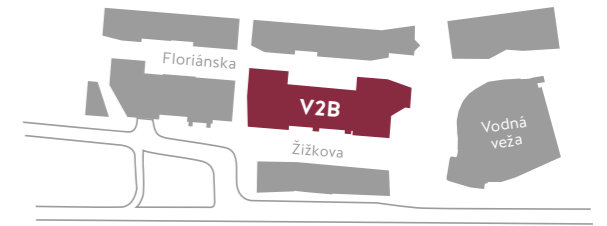
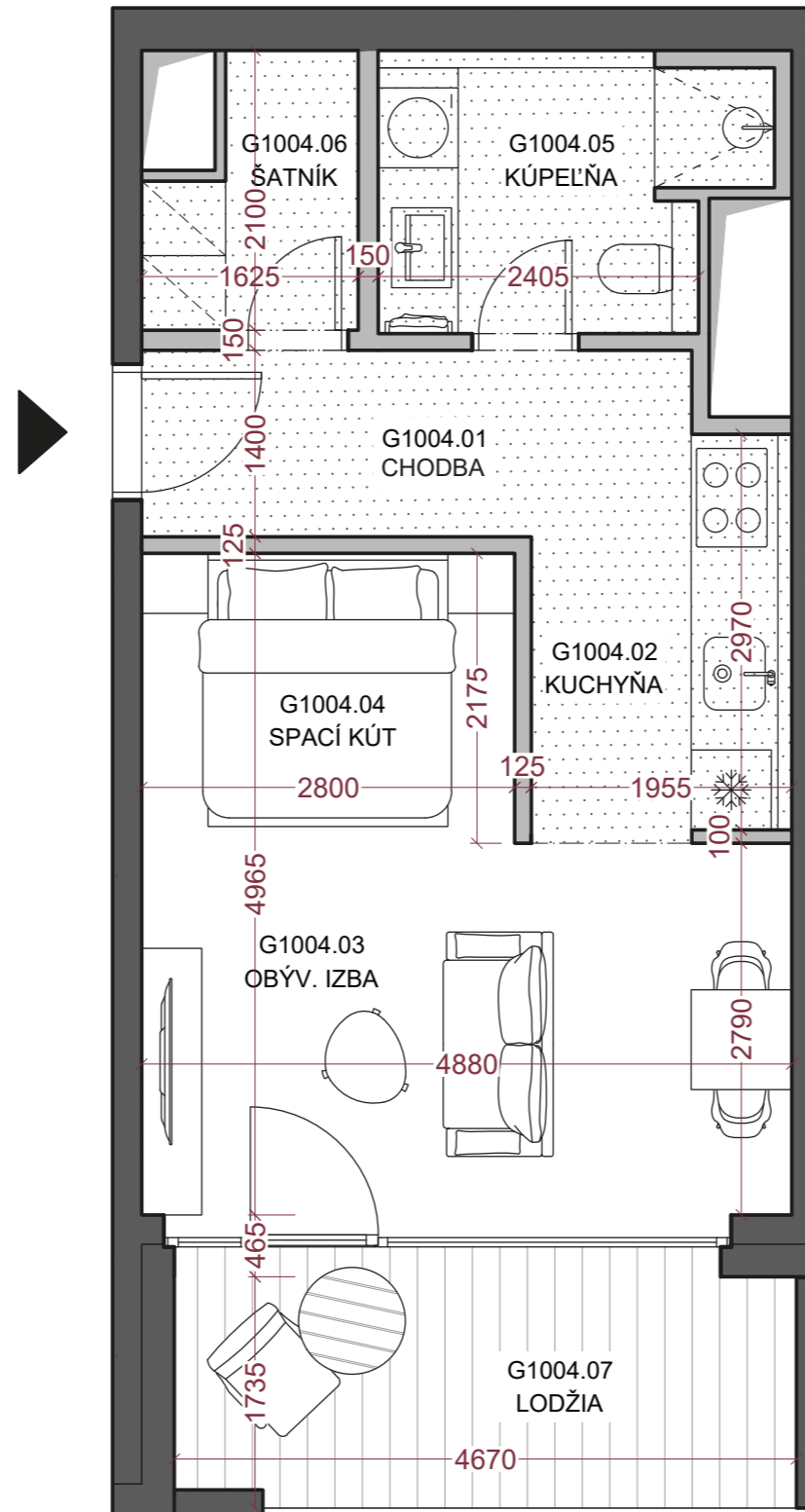

Plocha priestorov pod svetlou výškou do 1,3 m vo výmere - m<sup>2</sup> nie je započítaná do plochy apartmánu.

The part of the premises where floor-to-ceiling height is below 1,3 m, which means the area of - m<sup>2</sup>, is not included in the whole area of the apartment.

..... Znížená svetlá výška  
Lowered floor-to-ceiling height

**DEVELOPER:**  
VYDRICA DEVELOPMENT, a.s.  
STEINERKA Business Center  
Legionárska 10, 811 07 Bratislava

**PREDAJ/SALES:**  
+421 910 635 645 | predaj@vydrica.com  
www.vydrica.com