

**ČÍSLO APARTMÁNU**  
APARTMENT **E306**

**PODLAŽIE**  
FLOOR **3.NP**

**ČÍSLO DOMU**  
BUILDING **V2A**

**POČET IZIEB**  
ROOMS **2**

- 01. Chodba 5,3 m<sup>2</sup>  
01. Hall
- 02. Kuchyňa 9,5 m<sup>2</sup>  
02. Kitchen
- 03. Obývacia izba 13,7 m<sup>2</sup>  
03. Living room
- 04. Izba 13,1 m<sup>2</sup>  
04. Room
- 05. Kúpeľňa 5,8 m<sup>2</sup>  
05. Bathroom

**Plocha interiéru**  
Interior area **47,4 m<sup>2</sup>**

**Celková plocha apartmánu**  
Apartment area **47,40 m<sup>2</sup>**

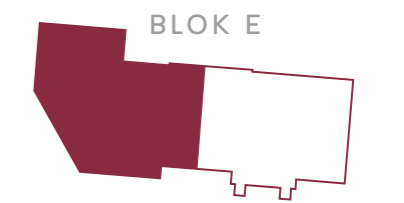
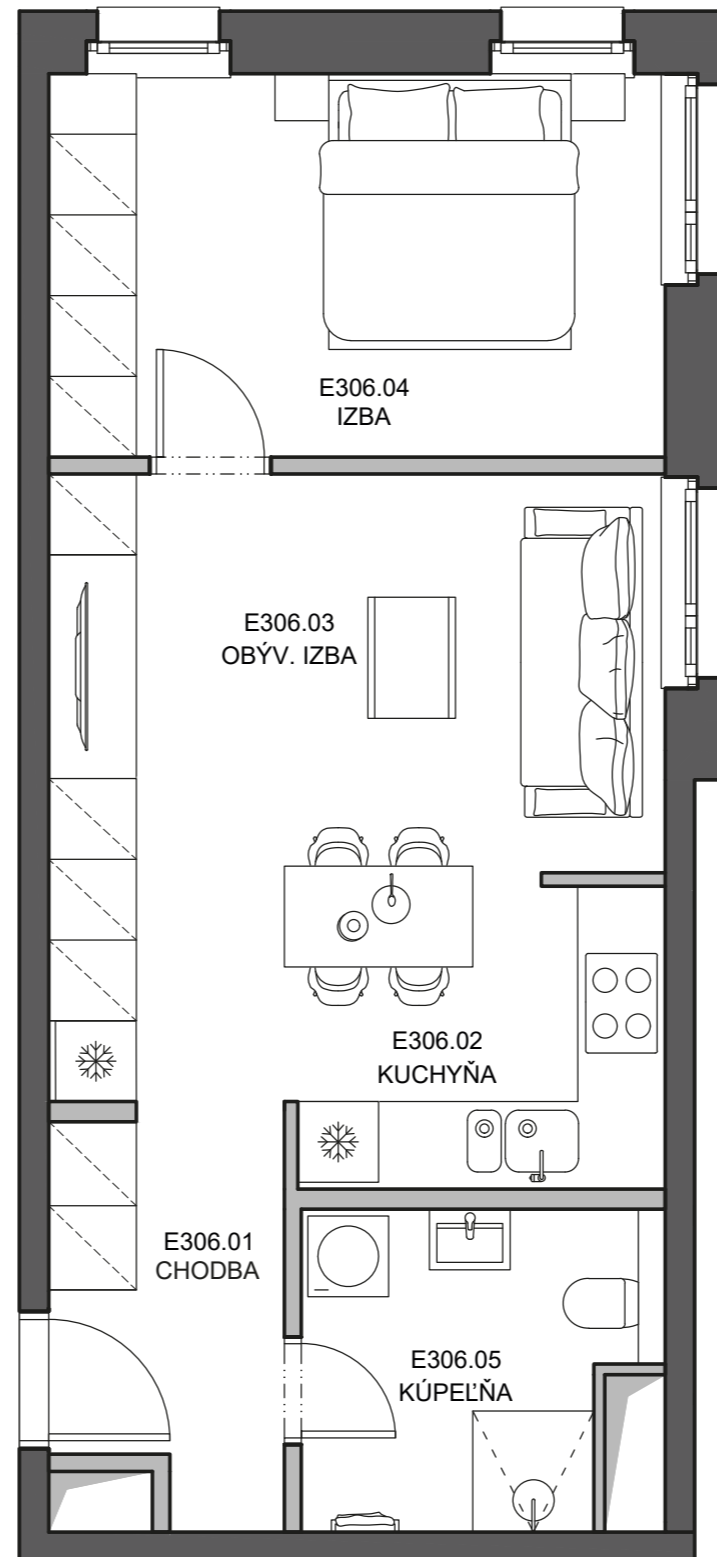

**DEVELOPER:**  
VYDRICA DEVELOPMENT, a.s.  
STEINERKA Business Center  
Legionárska 10, 811 07 Bratislava

**PREDAJ/SALES:**  
+421 910 635 645 | predaj@vydrica.com  
www.vydrica.com

ČÍSLO APARTMÁNU  
APARTMENT **E306**

PODLAŽIE  
FLOOR **3.NP**

ČÍSLO DOMU  
BUILDING **V2A**

POČET IZIEB  
ROOMS **2**

- 01. Chodba 5,3 m<sup>2</sup>  
01. Hall
- 02. Kuchyňa 9,5 m<sup>2</sup>  
02. Kitchen
- 03. Obývacia izba 13,7 m<sup>2</sup>  
03. Living room
- 04. Izba 13,1 m<sup>2</sup>  
04. Room
- 05. Kúpeľňa 5,8 m<sup>2</sup>  
05. Bathroom

**Plocha interiéru** **47,4 m<sup>2</sup>**  
Interior area

**Celková plocha apartmánu** **47,40 m<sup>2</sup>**  
Apartment area

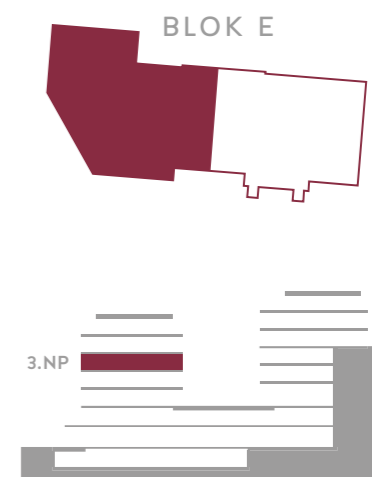
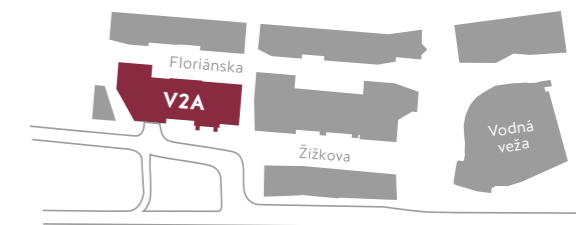
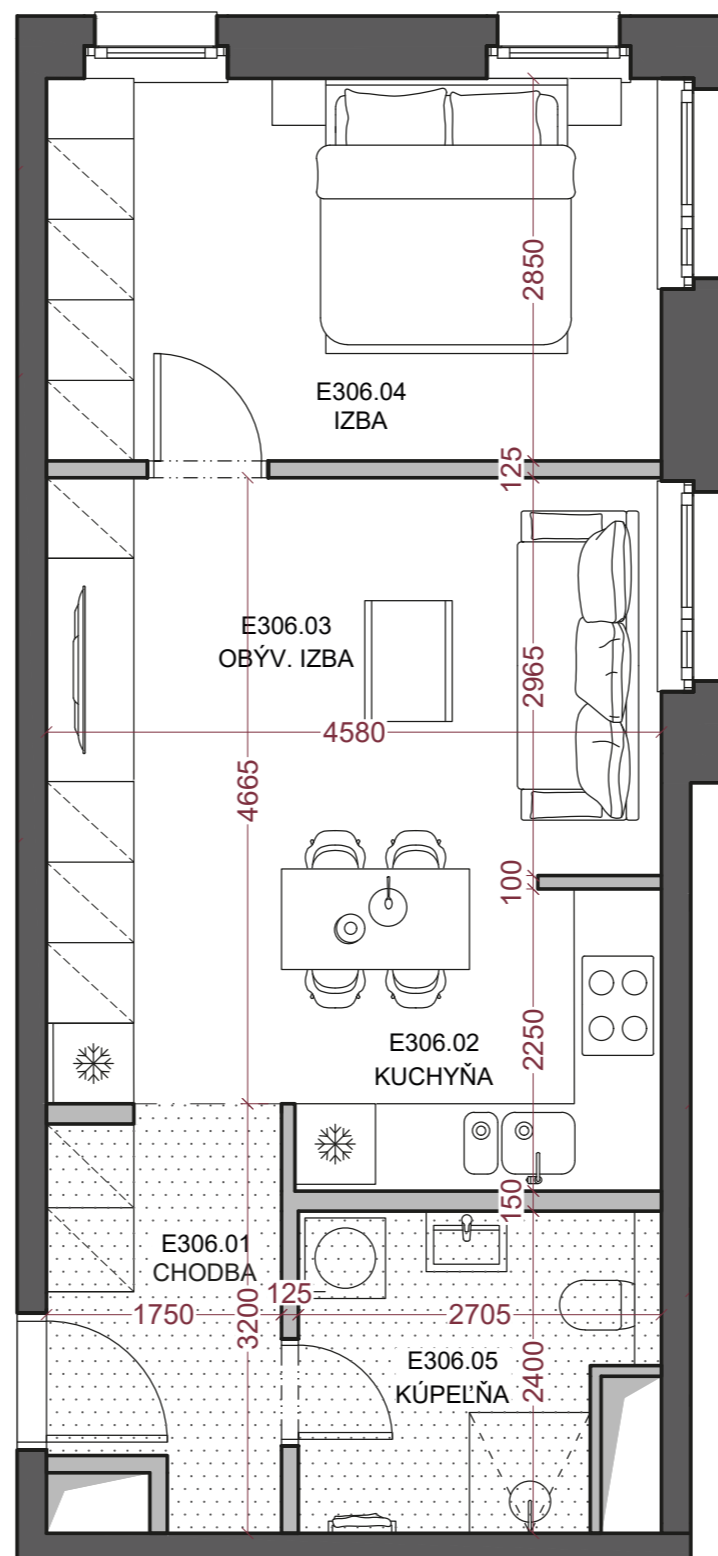

Plocha priestorov pod svetlou výškou do 1,3 m vo výmere - m<sup>2</sup> nie je započítaná do plochy apartmánu.

The part of the premises where floor-to-ceiling height is below 1,3 m, which means the area of - m<sup>2</sup>, is not included in the whole area of the apartment.

..... Znížená svetlá výška  
..... Lowered floor-to-ceiling height

**DEVELOPER:**  
VYDRICA DEVELOPMENT, a.s.  
STEINERKA Business Center  
Legionárska 10, 811 07 Bratislava

**PREDAJ/SALES:**  
+421 910 635 645 | predaj@vydrica.com  
www.vydrica.com